



M - MA Series

Catalogue 2019

An updated .pdf version of this manual is always available [here](#)

Pro DG Systems. Passion for high quality

More than 30 years of experience at the design, manufacture and selling of high quality and performance professional sound systems. The most advanced tools and innovative technology, an highly experienced and trained workforce in the complete design, manufacture and optimization process of acoustic equipment, hardware and all other related supplements.



An absolute control of the complete developing process by enforcing the most exigent quality control in every step of our sound systems manufacture, counting with our own carpentry and metal work department and the most experienced R + D department.

Advanced Sound Systems

The most effective customer and after-sales service, working closely with professionals worldwide to serve and assist the professional effectively in the shortest time possible.

Definitely, passion for high quality, soundness and warranty to satisfy all the requirements of the most exigent professionals.

An exciting project in constant evolution in which an increasing number of professionals around the world are taking part. Advanced Sound Systems.

100% Made in Spain



With European components

A handwritten signature in black ink, which appears to read 'José Carlos López'.

"Thanks to all our partners and friends who make possible this exciting project together"

José Carlos López. General Manager

Index. M Series & MA Series

M 10

- System overview	Pag 3
- Technical specifications	Pag 4
- Architectural specifications	Pag 4
- Hardware & Accessories	Pag 5

M 12 & MA 12

- System overview	Pag 6
- Technical specifications	Pag 7
- Architectural specifications	Pag 8
- Hardware & Accessories	Pag 8

M 15 & MA 15

- System overview	Pag 9
- Technical specifications	Pag 10
- Architectural specifications	Pag 11
- Hardware & Accessories	Pag 11

M 10 - System Overview



M 10 owns simply the best relationship between high performance, size and weight of the high end audio market, as is evidenced by its Power Handling of 350 W RMS / 700 W program / 1400 W peak. Average Sensitivity of 97 dB and its Maximum SPL peak of 131 dB.

Thanks to its superior performance, versatility, super compact size (500x310x283mm) and weight (13 Kg), using CNC construction of 18-15mm made from birch wood plated on the exterior, makes it even superior to other much bigger and heavy systems.

M 10 is a 2-way multipurpose passive system equipped with one (1) speaker of 10" in a tuned enclosure. The HF section has one (1) compression driver of 1", coupled to one (1) rotating diffuser of 90X50. **M 10** has been redesigned to offer an improved ergonomics and appearance.

This multipurpose system which has been also designed to be used a stage monitor is perfect to use as P.A, frontfill and sidefill with or without subwoofer, as portable system or permanent installation. Excellent as sonorous reinforcement for all our systems.

Integrated hardware and all type of installation accessories and equipment are available to offer the maximum interaction with our different systems. All type of detailed information about **M 10** is available at: www.prodgsystems.com.

Technical Specifications

Power Handling:	350 W RMS (EIA 426A standard) / 700 W program / 1400 W peak.
Nominal Impedance:	8 Ohm.
Average Sensitivity:	97 dB / 2.83 V/1m (average 150 - 16000 Hz wideband).
Maximum SPL Calculation:	/ 1m 125 dB continuous / 128 dB program / 131 dB peak
Frequency Range:	+/-3 dB from 60 Hz to 18 KHz.
Nominal Directivity:	90x50 rotating diffuser.
Low / Mid Frequency Driver:	One (1) Beyma speaker of 10", 8 Ohm, 300W, 254mm of diameter with high temperature glass fiber voice coil.
High Frequency Driver:	One (1) Beyma driver of 1", 8 Ohm, 50 W, 25mm exit (44.4 mm) with voice coil Mylar diaphragm.
Recommended Amplifier:	Pro DG Systems GT 1.2 H or Lab.gruppen FP 6000Q.
Rigging Points:	7 x M8
Connectors:	2 NL4MP Neutrik speakon connectors.
Acoustic Enclosure:	CNC model, 18-15mm made from birch plywood plated on the exterior.
Finish:	Standard finish in black paint of high weather resistance.
Cabinet Dimensions:	(HxWxD); 500x310x283mm (19,68"x12,20"x11,14").
Weight:	13 Kg (28,66 lbs) net / 14,2 Kg (31,31 lbs) with packaging.

Architectural Specifications

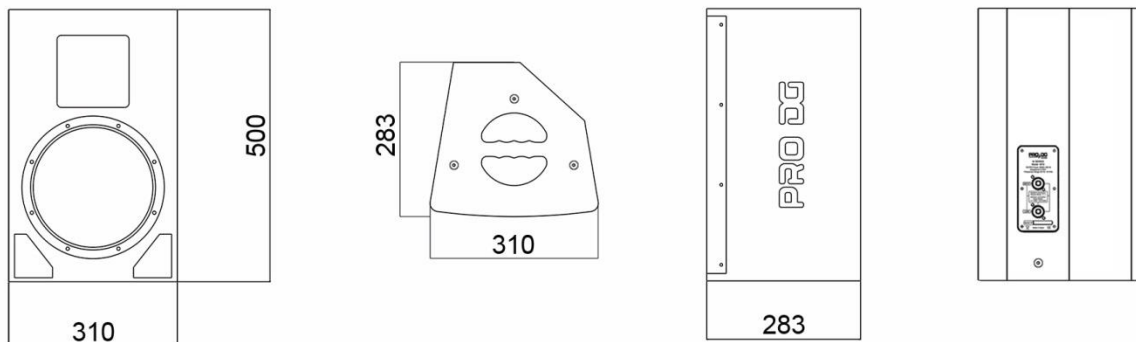

Hardware & Accessories

M 10 incorporates seven (7) rigging points offering the maximum versatility in function of the type of need or event. Available all type of installation and rigging hardware as:

- Eyebolt for wall and ceiling installation.
- Tripod and extensible accessory with thread and mounting fork for stacking mode with subwoofers.
- Wall mount bracket with steel mounting-pole and adjustable angulation.
- Flight Case to transport four (4) units **M 10**.

M 12 & MA 12 - System Overview



With a Power Handling of 550 W RMS / 1100 W program / 2200 W peak and Maximum SPL peak of 133 dB, a redesigned and improved ergonomics and appearance, offering a super compact size (605x365x340) and light weight (19 Kg), using CNC construction of 18-15mm made from birch wood plated on the exterior, **M 12** is presented as **the definitive all-purpose system**.

Even superior to other much bigger and heavy systems, this 2-way multipurpose system is equipped with one (1) speaker of 12" in a tuned enclosure. The HF section has one (1) compression driver of 1", coupled to one (1) rotating diffuser of 60X40, to provide with the maximum control and precision.

This multipurpose system which has been also designed to be used as a stage monitor is perfect to use as P.A, frontfill and sidefill with or without subwoofer, as portable system or permanent installation. Excellent as sonorous reinforcement for all our systems. It can be served in passive version (**M 12**) or self - powered version (**MA 12**), which includes inserted amplification module **GT 1.2 H**, offering the advantage of amplify itself and another passive unit **M 12** in slave mode.

Integrated hardware and all type of installation accessories and equipment are available to offer the maximum interaction with our different systems. All type of detailed information about **M 12** and **MA 12** is available at: www.prodgsystems.com.

Technical Specifications

Power Handling:	550 W RMS (EIA 426A standard) / 1100 W program / 2200 W peak.
Nominal Impedance:	8 Ohm.
Average Sensitivity:	99 dB / 2.83 V/1m (average 150 - 16000 Hz wideband).
Maximum SPL Calculation:	/ 1m 127 dB continuous / 130 dB program / 133 dB peak
Frequency Range:	+/-3 dB from 60 Hz to 18 KHz.
Nominal Directivity:	60x40 rotating diffuser.
Low / Mid Frequency Driver:	One (1) Beyma speaker of 12", 8 Ohm, 500 W, 330,2 mm of diameter with high temperature glass fiber voice coil.
High Frequency Driver:	One (1) Beyma driver of 1", 8 Ohm, 50 W, 25mm exit (44.4 mm) with voice coil Mylar diaphragm.
Recommended Amplifier *	Pro DG Systems GT 1.2 H or Lab.gruppen FP 6000Q.
Rigging Points:	9 x M8
Connectors **	2 NL4MP Neutrik speakon connectors.
Acoustic Enclosure:	CNC model, 18-15mm made from birch plywood plated on the exterior.
Finish:	Standard finish in black paint of high weather resistance.
Cabinet Dimensions:	(HxWxD); 605x365x340mm (23,82"x14,37"13,39").
Weight ***	19 Kg (41,89 lbs) net / 20,2 Kg (44,53 lbs) with packaging.

For MA 12

Recommended Amplifier *	Pro DG Systems GT 1.2 H into the cabinet.
Connectors **	2 X XLR + 1 NL4MP speakon connectors. USB-Ethernet + 2 X Powercom.
Weight ***	20,3 Kg (44,75 lbs) net / 21,5 Kg (47,40 lbs) with packaging.

Architectural Specifications (M 12)

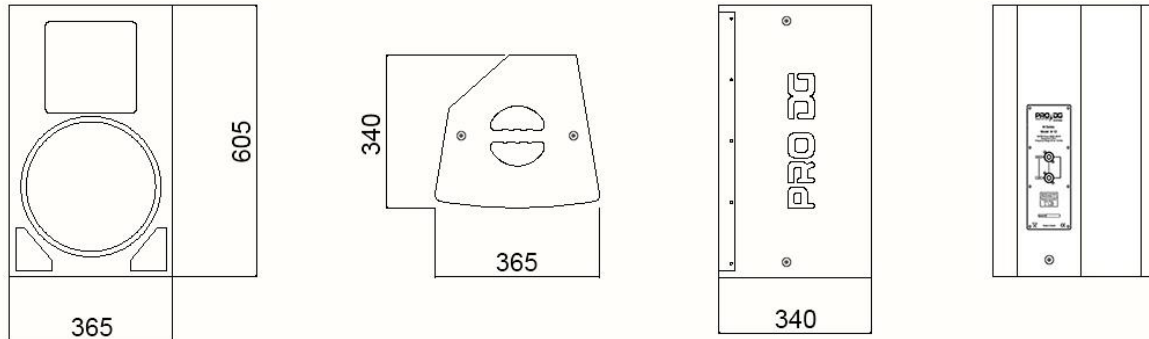

Architectural Specifications (MA 12)

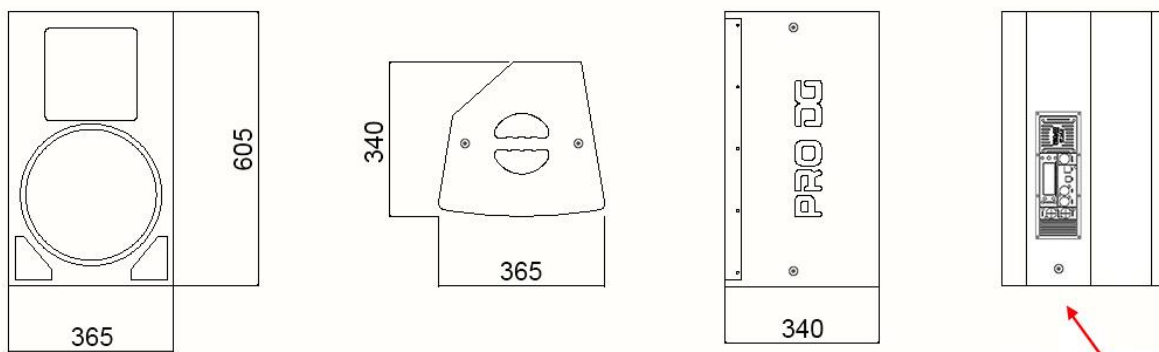

incorporates amplifier module **GT 1.2 H**

Hardware & Accessories

M 12 and **MA 12** incorporate seven (9) rigging points offering the maximum versatility in function of the type of need or event. Available all type of installation and rigging hardware as:

- Eyebolt for wall and ceiling installation.
- Tripod and extensible accessory with thread and mounting fork for stacking mode with subwoofers.
- Wall mount bracket with steel mounting-pole and adjustable angulation.
- Flight Case to transport two (2) units **M 12** or **MA 12**.

M 15 & MA 15 - System Overview



M 15 is the best multipurpose solution thanks to its unprecedented relationship between high performance, versatility, compact size and weight. A Power Handling of 750 W RMS / 1500 W program / 3000 W peak and Maximum SPL peak of 135 dB are just some data of its impressive presentation card.

Even superior to other much bigger and heavy systems, **M 15** counts with a new renovated design which provides with a much improved ergonomics and appearance, **M 15** is a 2-way multipurpose system equipped with one (1) speaker of 15" in a tuned enclosure. The HF section has one (1) compression driver of 1", coupled to one (1) rotating diffuser of 60X40, to provide with the maximum control and precision.

This multipurpose system which has been also designed to be used as a stage monitor is perfect to use as P.A, frontfill and sidefill with or without subwoofer, as portable system or permanent installation. It is excellent as sonorous reinforcement for all our systems. Ideal for all type of full-range applications thanks to its high performance and wide frequency range. It can be served in passive version (**M 15**) or self-powered version (**MA 15**), which includes inserted amplification module **GT 1.2 H**, offering the advantage of amplify itself and another passive unit **M 15** in slave mode.

Integrated hardware and all type of installation accessories and equipment are available. All type of detailed information about **M 15** and **MA 15** is available at: www.prodgsystems.com.

Technical Specifications

Power Handling:	750 W RMS (EIA 426A standard) / 1500 W program / 3000 W peak.
Nominal Impedance:	8 Ohm.
Average Sensitivity:	100 dB / 2.83 V/1m (average 150 - 16000 Hz wideband).
Maximum SPL Calculation:	/ 1m 129 dB continuous / 132 dB program / 135 dB peak
Frequency Range:	+/-3 dB from 50 Hz to 18 KHz.
Nominal Directivity:	60x40 rotating diffuser.
Low / Mid Frequency Driver:	One (1) Beyma speaker of 15", 8 Ohm, 700 W, 406mm of diameter with high temperature glass fiber voice coil.
High Frequency Driver:	One (1) Beyma driver of 1", 8 Ohm, 50 W, 25mm exit (44.4 mm) with voice coil Mylar diaphragm.
Recommended Amplifier *	Pro DG Systems GT 1.2 H or Lab.gruppen FP 6000Q.
Rigging Points:	9 x M8
Connectors **	2 NL4MP Neutrik speakon connectors.
Acoustic Enclosure:	CNC model, 18-15mm made from birch plywood plated on the exterior.
Finish:	Standard finish in black paint of high weather resistance.
Cabinet Dimensions:	(HxWxD); 755x435x395mm (29,72"x17,13"15,55").
Weight ***	29,5 Kg (65,04 lbs) net / 30,7 Kg (67,68 lbs) with packaging.

For MA 15

Recommended Amplifier *	Pro DG Systems GT 1.2 H into the cabinet.
Connectors **	2 X XLR + 1 NL4MP speakon connectors. USB-Ethernet + 2 X Powercom.
Weight ***	30,8 Kg (67,90 lbs) net / 32 Kg (70,55 lbs) with packaging.

Architectural Specifications (M 15)

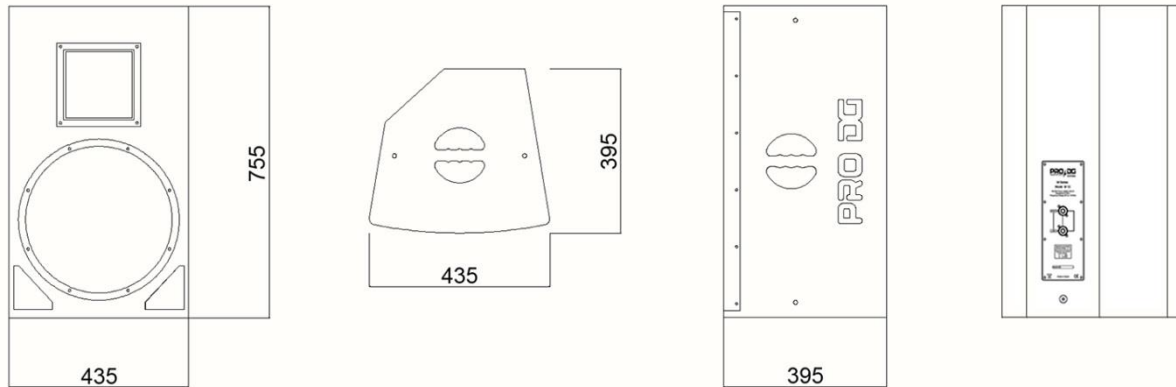

Architectural Specifications (MA 15)

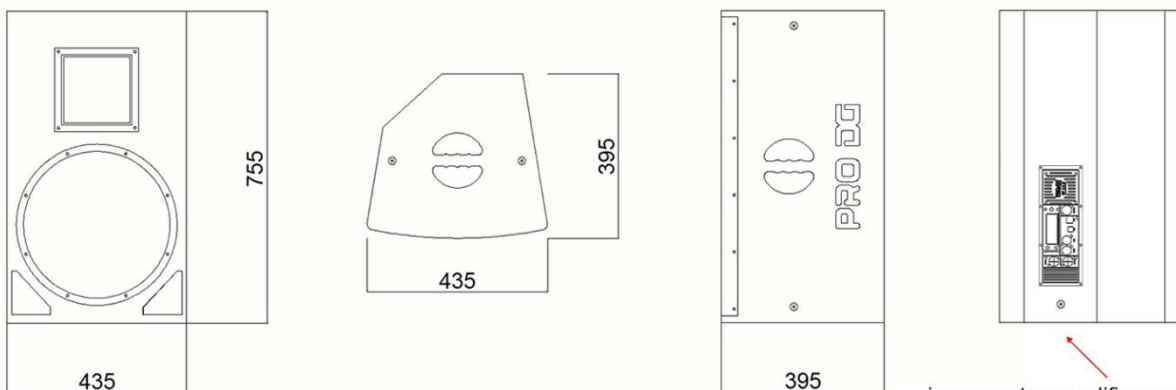

incorporates amplifier module GT 1.2 H

Hardware & Accessories

M 15 and **MA 15** incorporate seven (9) rigging points offering the maximum versatility in function of the type of need or event. Available all type of installation and rigging hardware as:

- Eyebolt for wall and ceiling installation.
- Tripod and extensible accessory with thread and mounting fork for stacking mode with subwoofers.
- Wall mount bracket with steel mounting-pole and adjustable angulation.
- Flight Case to transport two (2) units **M 15** or **MA 15**.



www.prodgsystems.com

≡ Advanced Sound Systems ≡